

These particulars, whilst believed to be accurate are set out as a general outline only for guidance and do not constitute any part of an offer or contract. Intending purchasers should not rely on them as statements of representation of fact, but must satisfy themselves by inspection or otherwise as to their accuracy. No person in this firm's employment has the authority to make or give any representation or warranty in respect of the property.

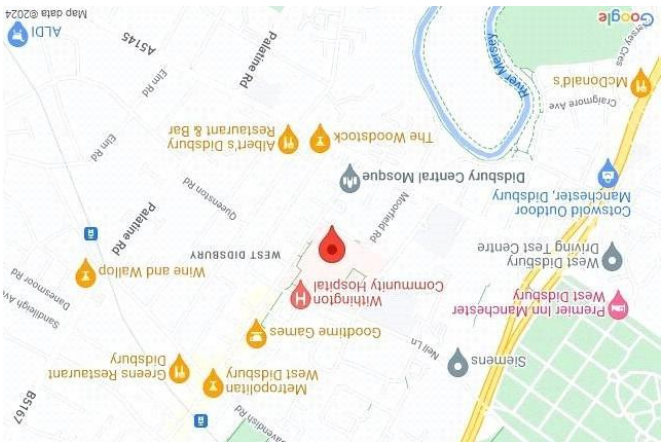

Whilst every attempt has been made to ensure the accuracy of the floor plan contained here, measurements of doors, windows, rooms and any other items are approximate and no responsibility is taken for any omission, or mis-statement. This plan is for illustrative purposes only and should be used as such by any prospective purchaser. The services, systems and appliances shown have not been tested and no guarantee as to their operability or efficiency can be given
Made with Metropix ©2015

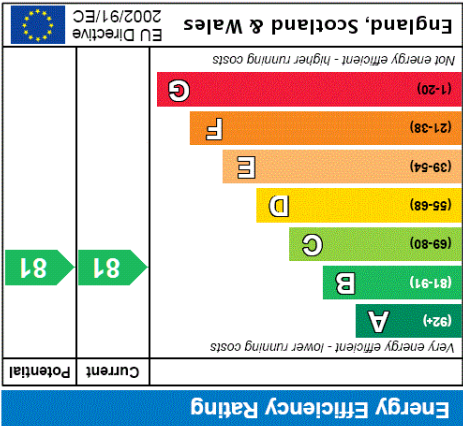
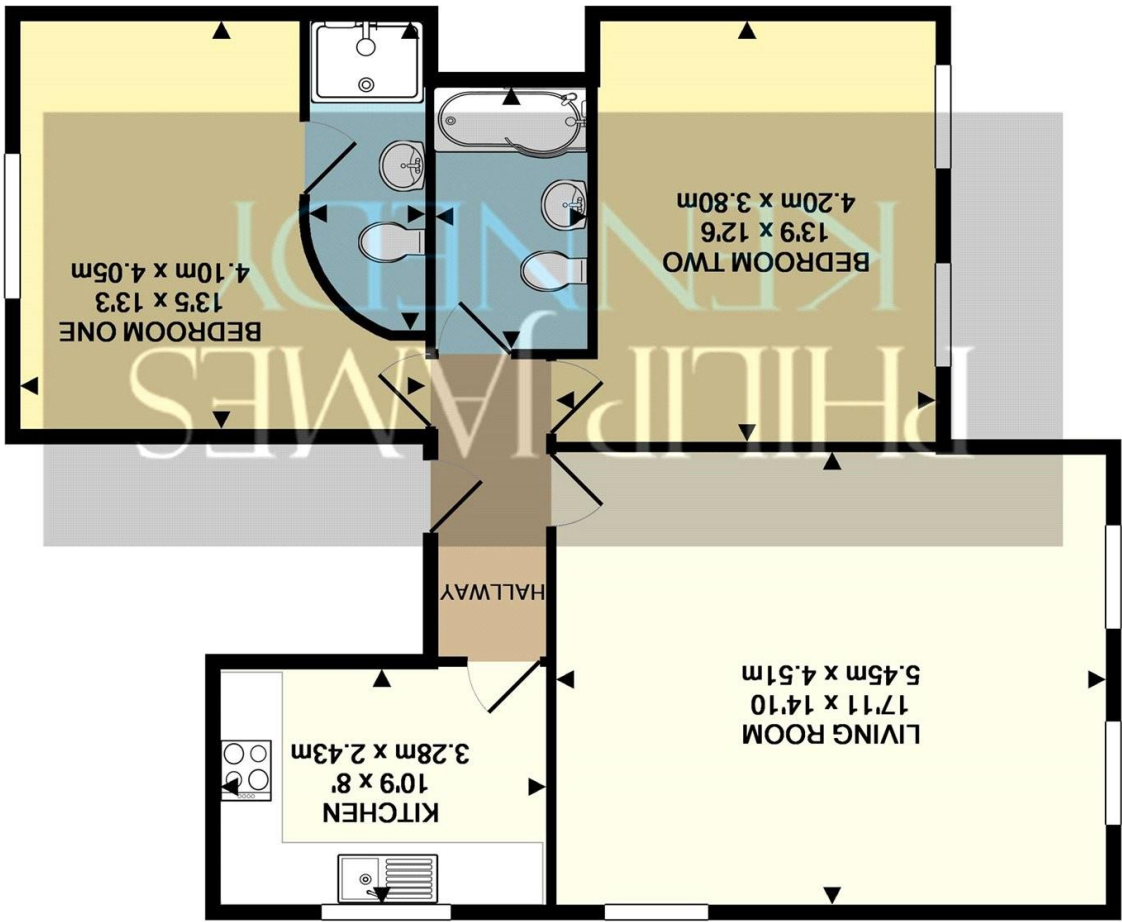

679-681 Wilmslow Road, Didsbury, Manchester, M20 6RA
0161 448 1234 | didsbury@philipjames.co.uk
www.philipjames.co.uk

PHILIP JAMES KENNEDY



PHILIP JAMES
KENNEDY

FLAT 5, WESTFIELD HOUSE
280-282 BURTON ROAD, WEST DIDSBURY, M20 2DH



ASKING PRICE £280,000

A STYLISH FIRST FLOOR APARTMENT within this ATTRACTIVE CONVERTED VICTORIAN MANSION, with WELL-PROPORTIONED ACCOMMODATION and SECURE GATED PARKING, located just a moment's stroll from West Didsbury Village. Offered For Sale with No Onward Chain. 769 Sq Ft

The accommodation reveals an entrance hallway opening to all rooms.

There is bright and spacious open plan living and dining area with dual aspect windows.

The separate kitchen is fitted with ample modern wall and base units with integrated appliances.

There are two double bedrooms both with bespoke fitted wardrobes, with the principal bedroom having a feature curved wall and a contemporary en-suite shower room.

The property is further served by a stylish bathroom with frosted glass basin, WC and shower bath with shower over.

The property is accessed via an intercom entry system. There are attractive shared gardens to the front of the development and allocated parking to the rear. All of these are accessed by remote operated gates.

Leasehold/ 150 years from June 2003
Service Charge/ £143.94pcm
Ground Rent/ £175 Per annum
Council Tax Band: D

*"Stylish Apartment In
Prime West Didsbury
Location"*

