

www.philipjames.co.uk
 0161 448 1234 | didsbury@philipjames.co.uk
 679-681 Wilmslow Road, Didsbury, Manchester, M20 6RA

PJK

These particulars, whilst believed to be accurate are set out as a general outline only for guidance and do not constitute any part of an offer or contract. Intending purchasers should not rely on them as statements of representation of fact, but must satisfy themselves by inspection or otherwise as to their accuracy. No person in this firm's employment has the authority to make or give any representation or warranty in respect of the property.

What every attempt has been made to ensure the accuracy of the floorplan contained here, measurements of doors, windows, rooms and other items are approximate and no responsibility is taken for any error or mis-statement. The plan is illustrative purposes only and should be used as such by any prospective purchaser. The services, systems and appliances shown have not been tested and no guarantee as to their operability or efficiency can be given.
 Made with Metropix 5/2020

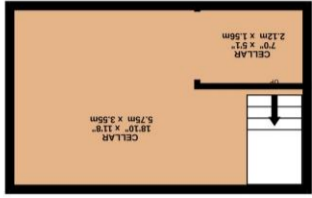
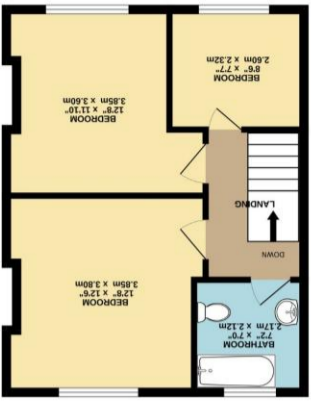

PHILIP JAMES
 KENNEDY

27 ARLEY AVENUE
 WEST DIDSBURY, M20 2LQ



ASKING PRICE £475,000

An EXCEPTIONAL VICTORIAN MID-TERRACE offering BEAUTIFULLY PRESENTED accommodation and perfectly blending PERIOD CHARACTER with MODERN STYLE. Located in the heart of West Didsbury, just a short stroll from fashionable Burton Road, its array of independent shops, bars, and restaurants, and the Metrolink station, providing superb access into Manchester city centre. Approx. 1135 Sq.Ft

Internally, the property opens into a welcoming hallway, leading you through to the bright living room featuring a large bay window, high ceilings, and a working log burner, creating a warm and inviting space for day to day family living.

To the rear is an open-plan dining kitchen room, boasting bespoke wooden work surfaces and units with integrated appliances. The room is bathed in natural light from the patio doors which open out into the Westerly facing garden. A door from the kitchen also provides access to the cellar with ample space for storage.

The first floor offers two generous double bedrooms, and a further single bedroom, which could also be a study/nursery.

The bedrooms are served by a contemporary family bathroom.

Externally, on-street parking is available to the front, while to the rear there is a fully enclosed Westerly facing paved garden — perfect for outdoor entertaining.

Freehold
Council Tax Band: C
Approx. 1135 Sq.Ft

*"Beautiful Three Bedroom
Victorian Terrace in the
Heart of West Didsbury"*

